

1 PROPOSED SOUTH WEST ELEVATION - TACK SITE
1 : 200

PLANNING

REV	DATE	DESCRIPTION	BY
4	04/04/2022	SHD3	AT

MATERIALS LEGEND

- ① OFF WHITE BRICK
- ③ MEDIUM / DARK GREY BRICK
- ⑤ METAL FRAME
- ② LIGHT GREY BRICK
- ④ LIGHT GREY METAL CLADDING PANEL
- ⑥ GLASS SPANDREL CLADDING PANEL

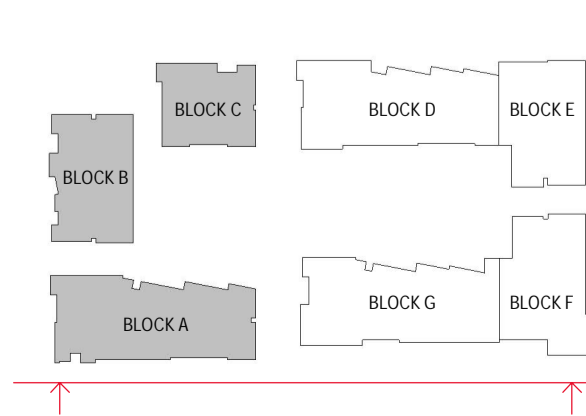

APPROVED BY
Sallen

Client: SANDYFORD ENVIRONMENTAL CONSTRUCTION LIMITED
 Project: TACK SANDYFORD SHD
 Title: PROPOSED SOUTH WEST ELEVATION - TACK SITE
 Sheet No.: 1081-MDO-TS-ZZ-DR-A-08006
 Scale as: As indicated @ A1 Current Rev.: 3 Project No.: 1081

MC CAULEY DAYE O'CONNELL
ARCHITECTS

11 Merrion Square, Dublin 2, Ireland
 Telephone: +353 (0)1 400 4171
 info@mdo.ie | www.mdo.ie

DO NOT SCALE | USE FIGURED DIMENSIONS ONLY | NOTIFY THE ARCHITECTS OF ANY DISCREPANCIES ON THE DRAWING PRIOR TO WORK PROCEEDING | THIS DRAWING IS COPYRIGHT OF MCCALEY DAYE O'CONNELL ARCHITECTS